



GENERAL APPLICABILITY

LEXUS 570

KIT CONTENTS

ITEM	QTY	DESCRIPTION
1	2	LED DAYTIME RUNNING LIGHTS*
2	1	CONTROL MODULE
3	1	DRL EXTENSION HARNESS
4	1	CONTROL MODULE MOUNTING BRACKET
5	1	HARDWARE PACKAGE
6	1	HEADLIGHT CONNECTION HARNESS
7	1	WIRE TIES

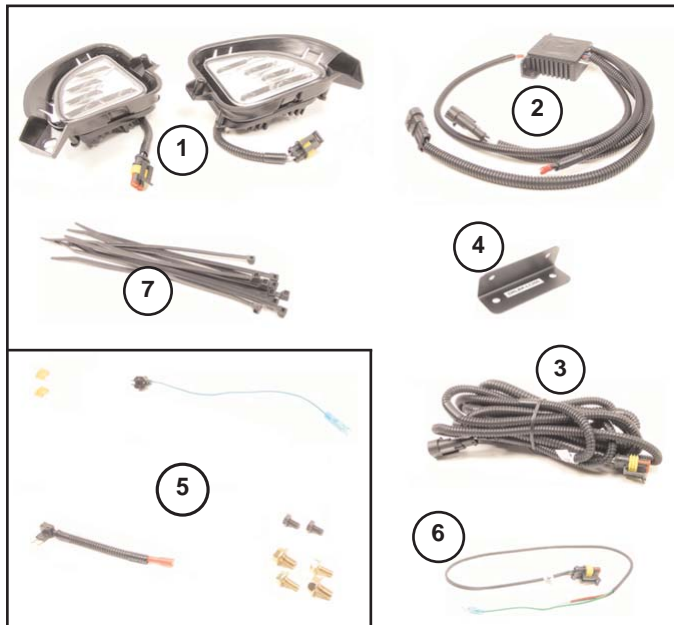

RECOMMENDED TOOLS

PERSONAL & VEHICLE PROTECTION	
SAFETY GLASSES	
MASKING TAPE	
SPECIAL TOOLS	
VOLT-OHM METER	
RECOMMENDED INSTALLATION TOOLS	
TRIM REMOVAL TOOL	PHILLIPS SCREWDRIVER
TAPE MEASURE	10-MM WRENCH
DRILL BITS	SOLDERING TOOL
WIRE CUTTERS	SHARP KNIFE
SPECIAL CHEMICALS	

CONFLICTS

NOTE:

LEGEND

	STOP: DAMAGE TO VEHICLE MAY OCCUR. DO NOT PROCEED UNTIL PROCESS COMPLIANCE HAS BEEN MET.
	OPERATOR SAFETY: USE CAUTION TO AVOID RISK OF INJURY.
	CRITICAL PROCESS: PROCEED WITH CAUTION TO ENSURE A QUALITY INSTALLATION. THESE POINTS WILL BE AUDITED ON A COMPLETED VEHICLE INSTALLATION.
	GENERAL PROCESS: THIS HIGHLIGHTS SPECIFIC PROCESSES TO ENSURE A QUALITY INSTALLATION. THESE POINTS WILL BE AUDITED DURING THE ACCESSORY INSTALLATION.
	TOOLS & EQUIPMENT: THIS CALLS OUT THE SPECIFIC TOOLS AND EQUIPMENT REQUIRED FOR THE PROCESS.
	REVISION MARK: THIS MARK HIGHLIGHTS A CHANGE IN INSTALLATION WITH RESPECT TO PREVIOUS ISSUE.

INSTALLATION

DRL MOUNTING INSTRUCTIONS

1. USING SUPPLIED HARDWARE, MOUNT CONTROL MODULE TO THE CONTROL MODULE BRACKET.
2. MOUNT THE CONTROL MODULE/BACKET ASSEMBLY TO THE DRIVER'S SIDE FENDER AS SHOWN IN **FIGURE 1**.
3. CONNECT GROUND RING OF HARNESS TO GROUND POINT NEXT TO CONTROL MODULE. **FIGURE 1**
4. CONNECT DRLTS-HSMLC HARNESS TO THE CONTROL MODULE HARNESS. CONNECT THE GREEN LEAD TO THE **HOT** SIDE OF THE HEAD LAMP.

NOTE: THE BLACK AND RED WIRES FROM THE DRLTS-HSMLC HARNESS ARE NOT USED AND MUST BE TAPED AND SECURELY FASTENED TO PREVENT AN ELECTRICAL SHORT.

5. PLUG IN DRLEX-LC200 HARNESS AND ROUTE THE LEADS TO THE FRONT CORNERS OF THE VEHICLE.
6. ACCESS UNDER-HOOD FUSE BLOCK ON DRIVER'S SIDE FENDER WELL. REMOVE THE 15 AMP FR FOG FUSE. **FIGURE 2**
7. INSERT SUPPLIED 5 AMP DRL FUSE IN LINE WITH RED WIRE OF SUPPLIED DRL FUSE HARNESS. INSERT THE 15 AMP FR FOG FUSE IN POSITION CLOSEST TO FUSE HARNESS SPADE TERMINALS. REFER TO **FIGURE 3**.
8. PLUG DRL FUSE HARNESS INTO THE SECURITY FUSE POSITION OF THE FUSE BLOCK WHERE 15 AMP FUSE WAS PREVIOUSLY LOCATED.

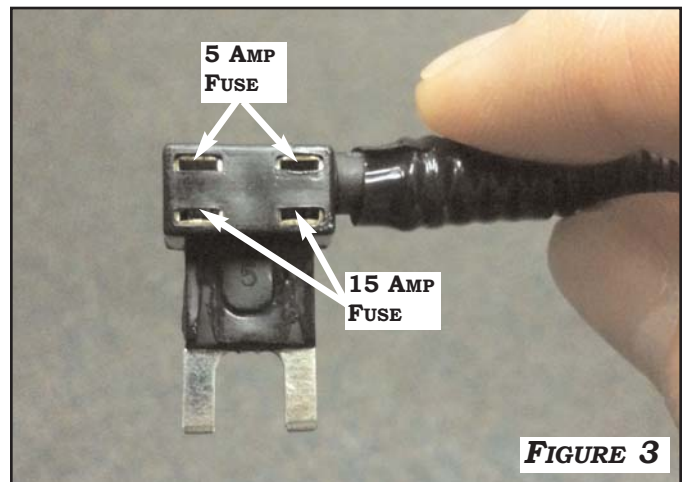
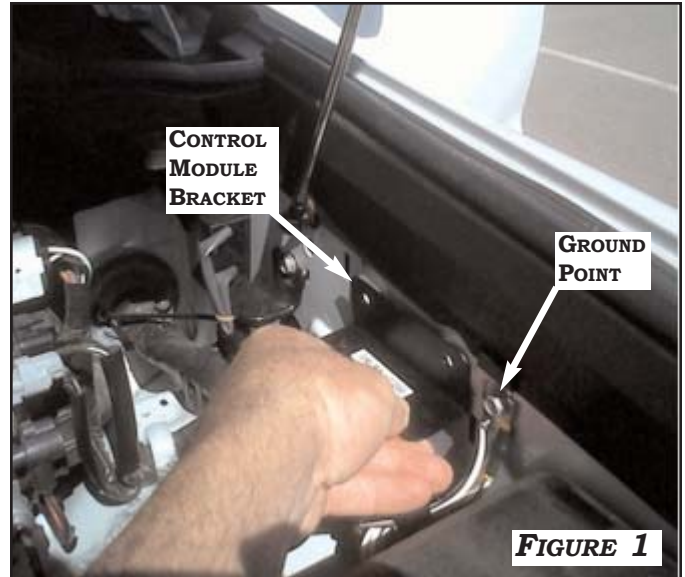

INSTALLATION

DRL MOUNTING INSTRUCTIONS (CONT.)

9. REMOVE INNER FENDER COMPONENTS TO GAIN ACCESS TO THE BACK OF THE FOG LIGHT.

10. REMOVE THE DRL BLANK. AND REPLACE WITH DRLS FROM KIT. **FIGURES 4, 5 & 6**

12. CONNECT THE DRLS ON EACH SIDE OF THE VEHICLE TO THE DRLEX-LC200 HARNESS.

13. USE WIRE TIES TO SECURE WIRING. BE SURE ALL WIRES ARE AWAY FROM ANY SHARP OBJECTS OR PINCH POINTS.

14. REASSEMBLE VEHICLE AND TEST FUNCTION.

